

# YF Series

## 4 Tumbler Miniature Switchlocks



### Description

The YF series 4 tumbler miniature switchlock is perfect for use in cash registers, point-of-sale terminals and server hardware. The high-quality YF series features multi-pole and multi-position options, positive detent and can operate at a low power level.

### Features & Benefits

- Multi-pole and multi-position
- Low level and power capability
- Positive detent

### Applications

- Computer servers
- Point-of-sale terminals
- Cash registers

### Agency Approvals

Agency	Agency File Number
	E42363

### Specifications

<b>Contact Ratings</b>	Q contact material: 4 amps @ 125 V AC or 28 V DC; 2 amps @ 250 V AC (UL). See page 3 for additional ratings.
<b>Contact Resistance</b>	Below 10 m Ω typ. initial @ 2-4 V DC, 100 mA, for both silver and gold plated contacts.

### Electrical Characteristics

<b>Electrical Life</b>	10,000 make-and-break cycles at full load.
<b>Insulation Resistance</b>	10 <sup>9</sup> Ω min.
<b>Dielectric Strength</b>	1,000 Vrms min. @ sea level.
<b>Indexing</b>	90°: 2 positions max.

### Materials

<b>Lock</b>	Zinc alloy with stainless steel facing. 4 tumbler, single bitted lock with integral detent mechanism.
<b>Keys</b>	Two nickel plated brass keys with code number.
<b>Switch Housing</b>	6/6 Nylon (UL 94 V-2).
<b>Contacts and Terminals</b>	Q contact material: Copper, silver plated. See page 3 for additional contact materials.
<b>Mounting Nut</b>	Brass, bright zinc plated.
<b>Terminal Seal</b>	Epoxy

#### Notes:

Any models supplied with Q or B contact material are RoHS compliant. Specifications and materials listed above are for switchlocks with standard options. For information on specific and custom switchlocks, consult Customer Service Center.

### Ordering Number

To order, simply select desired option from each category and place in the appropriate box. For additional options not shown in catalog, consult Customer Service Center.

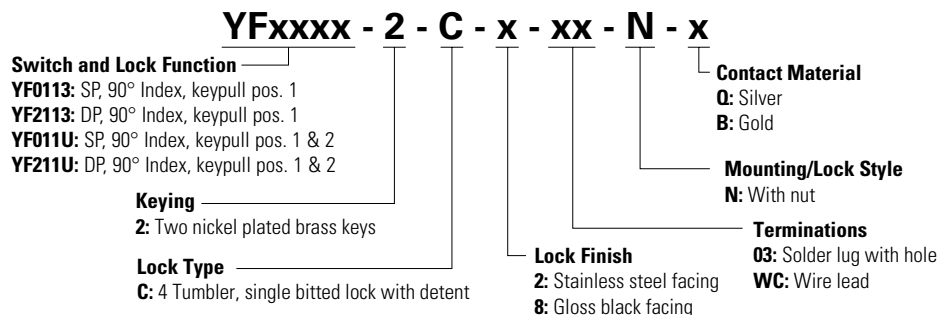

Notes: All models with all options when ordered with 'Q' contact material.

# YF Series

## 4 Tumbler Miniature Switchlocks



### Switch and Lock Function

#### Single & Double Pole Switches

No. Poles	Model No.	Connected Terminals			Key Pull Positions	Lock Configuration	Indexing
		POS. 1	POS. 2	POS. 3			
SP, DP	YF0113 YF2113	8-1	1-3, 1-3, 5-7	-	Position 1		90°
	YF011U YF211U	8-1, 4-5	1-3, 5-7	-	Position 1 & 2		

Notes: All models us with all options when ordered with 'Q' contact material.

#### Legend

- = Detent Positions (45° or 90°)
- = Key pull possible in these positions.
- = Stop Positions

#### Terminal Numbers

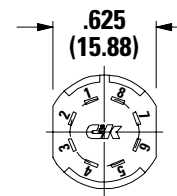

Notes: Terminal numbers molded on bottom of housing.

#### YF Series Dimensions - inches (mm)

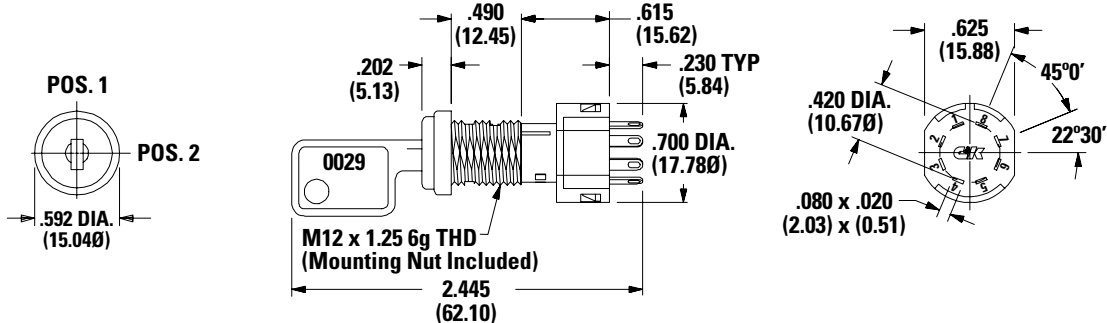

Notes: Terminal numbers molded on housing. Part number shown: YF01132C203NQ

#### Keying

##### 2 Two Nickel Plated Brass Keys

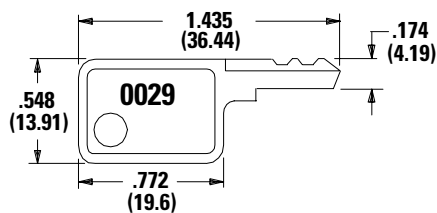

Note: All orders keyed alike with code number on key. For more than one key code, replacement keys, or other special features, consult Customer Service Center.

Key Part Number: 960B10029

#### Lock Type

##### C 4 Tumbler, Single Bitted Lock with Detent

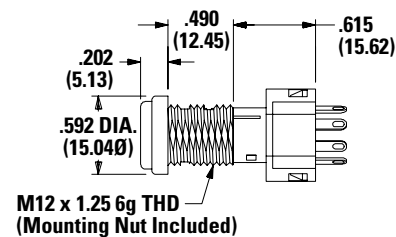

# YF Series

## 4 Tumbler Miniature Switchlocks



### Lock Finish

#### 2 Stainless Steel Facing



#### 8 Gloss Black Facing



### Terminations

#### 03 Solder Lug with Hole

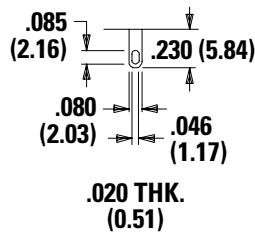

#### WC Wire Lead

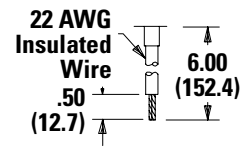

**Note:** Black wire standard, other colors and lengths available, consult Customer Service Center. UL style 1015.

### Mounting Style

#### N with Nut

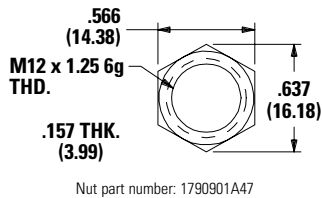

#### Panel Mounting

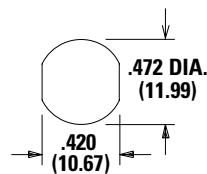

**Panel Thickness:**  
.300 (7.62) max.

### Switch and Lock Assembly Instructions

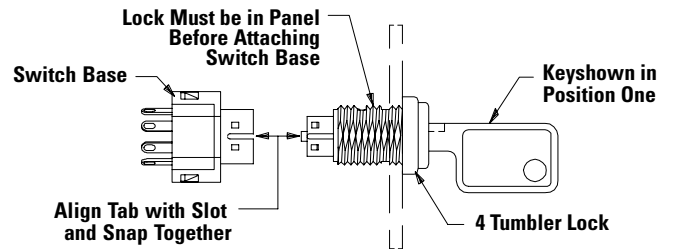

**Note:** Switch installation is permanent. Switch cannot be removed from lock after assembly. Attempts to separate switch and lock may damage switch.

# YF Series

## 4 Tumbler Miniature Switchlocks



### Contact Material

Option Code	ROHS Compliant <sup>1</sup>	ROHS Compatible <sup>1</sup>	Contact and Terminal Material		Rating
Q	Yes	Yes	Silver <sup>2</sup>	Power	4 amps @ 125 V AC or 28 V DC; 2 amps @ 250 V AC <sup>3</sup>
B	Yes	Yes	Gold <sup>1</sup>	Low Level / Dry Circuit	0.4 VA max. @ 20 V AC or DC max.

**Note:** See Technical Data section of this catalog for RoHS compliant and compatible definitions and specifications.

**1. Contacts & Terminals:** Copper, with gold plate over nickel plate.

**2. Contacts & Terminals:** Copper, silver plated (std. with all termination options).

**3.** All models  with all options when ordered with 'G' or 'Q' contact material.

### Available Hardware



**Material:** Brass

**Finish:** Nickel plate

**Key Code:** 0029

**Part No.** (One Key) 960B10029

**Disclaimer Notice** - Information furnished is believed to be accurate and reliable. However, users should independently evaluate the suitability of and test each product selected for their own applications. Littelfuse products are not designed for, and may not be used in, all applications. Read complete Disclaimer Notice at <http://www.littelfuse.com/disclaimer-electronics>.