

DM Series

Miniature 2 Pole Power Rocker Switches



Description

The DM series miniature 2 pole power rocker switch is commonly found in computers, appliances and electric tools – applications where there is the need for a quick connection and to be sure a device isn't turned on accidentally. DM switches feature quick connect terminals, optional recessed brackets (to prevent accidental actuation) and are double pole in miniature size.

Features & Benefits

- 5 amps to 10 amps
- Quick connect terminals
- Double pole in miniature size
- RoHS compliant

Applications

- Computers
- Appliances
- Electric tools

Agency Approvals

Agency	Agency File Number
	E42363

Notes:
Any models supplied with Q contact material are RoHS compliant. Specifications and materials listed above are for standard switches. For information on specific and custom switches, consult Customer Service Center.

Specifications

Contact Rating	DM61, DM62: GP (general purpose) 10 amps 125 VAC 50/60 Hz T85 10,000 cycles, 5 amps 250 VAC 50/60 Hz T85 10,000 cycles, R (resistive) 10 amps 30 VDC T85 10,000 cycles
Electrical Life	10,000 make-and-break cycles at full load.
Dielectric Strength	1,000 Vrms min. @ sea level.
Insulation Resistance	10 ⁹ Ω min.
Operating Temperature	-20°C to 65°C

Materials

Actuator & Housing	6/6 nylon (UI 94V-2), black.
Movable Contacts	DM6X models: Coin silver, silver plated.
Stationary Contacts and Terminals	Copper or brass, silver plated.
Contact Spring	Music wire or stainless steel.

Ordering Number

To order, simply select desired option from each category and place in the appropriate box. For additional options not shown in catalog, consult Customer Service Center.

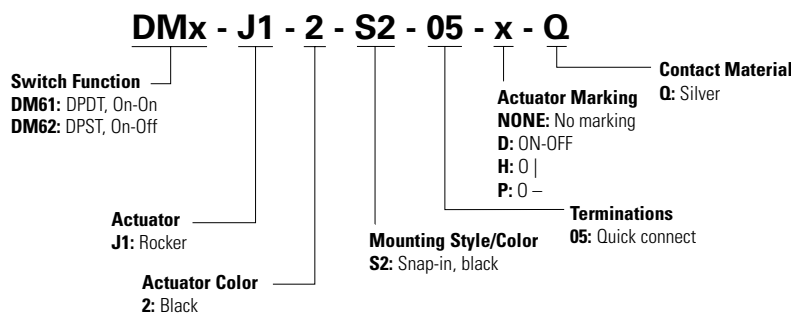

DM Series

Miniature 2 Pole Power Rocker Switches



Switch Function

DPDT

No. Poles	Model No.	Amp Rating ¹	Switch Function		Connected Terminals		Schematic
			C&K marking on opposite side				
			POS.1	POS.2	POS.1	POS.2	
DP	DM62	10	ON	OFF	1-1A, 2-2A	OPEN	
DP	DM61	10	ON	ON	1-1A, 2-2A	1-1B, 2-2B	

Part Number: J1XS205Q inches (mm)

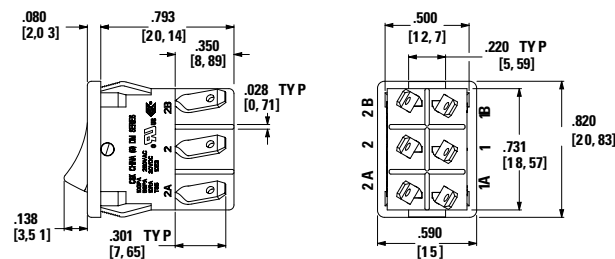

Notes: C UL 61058-1 tested to 30C temperature rise @ 6,000 cycles.
Actuator shown in position 1 - 'ON' position

Actuator inches (mm)

J1 Rocker

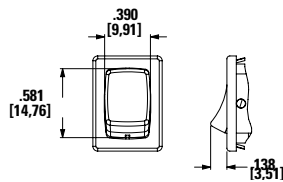

Housing Style/Color inches (mm)

S2 Snap-in, Black

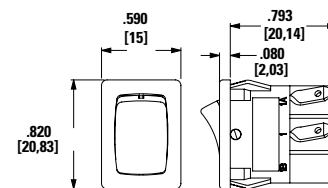

Note: Housing finish: matte. Other colors available, consult Customer Service Center.

Option Code	Actuator Color
2	Black

Note: Actuator finish: matte. Other colors available, consult Customer Service Center.

Actuators

None No Marking

D On-Off

H O |

P O -



Note: Orientation of actuator markings and terminals.
'D & P' marking options: marking color white, standard for all actuator colors except white actuators. Black marking color standard for white actuators. Consult Customer Service Center for other available marking colors.

Terminations inches (mm)

05 Quick Connect

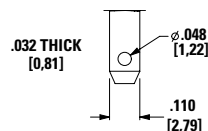

DM Series

Miniature 2 Pole Power Rocker Switches



Contact Material

Option Code	Contact and Terminal Material	Ratings
Q	Silver ^{1,2}	DM61, DM62: GP (general purpose) 10 amps 125 VAC 50/60 Hz T85 10,000 cycles, 5 amps 250 VAC 50/60 Hz T85 10,000 cycles, R (resistive) 10 amps 30 VDC T85 10,000 cycles

Notes: See Technical Data section of this catalog for RoHS compliant and compatible definitions and specifications.

1. **Movable Contact:** D50X and D60X Models: Coin silver, silver plated.

2. **Stationary Contacts & Terminals:** Copper or brass, silver plated.

Any models supplied with Q contact material are RoHS compliant. us

Available Hardware

Insert inches (mm)

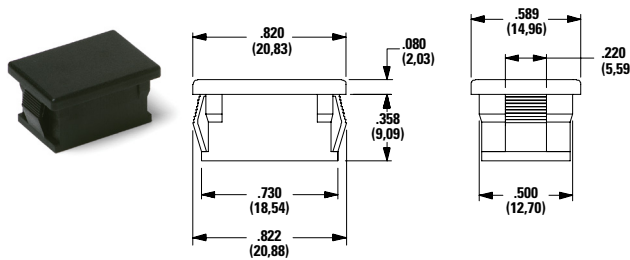

Part No. 057190200 Black

Material: Nylon 6/6

Finish: Matte

Actuator Guard inches (mm)

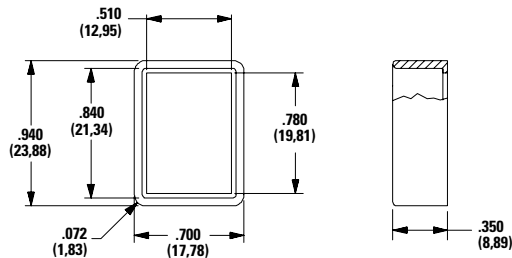

Part No. 104C22000

Material: PBT thermoplastic

Finish: Matte

Part No. 216C00000 IP54 Splash Proof Rubber Boot

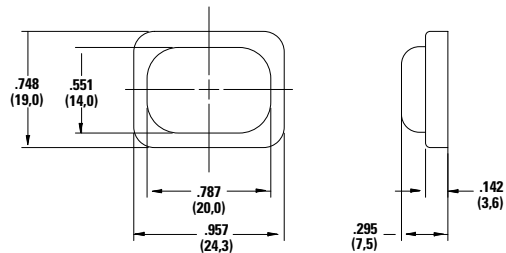

Disclaimer Notice - Information furnished is believed to be accurate and reliable. However, users should independently evaluate the suitability of and test each product selected for their own applications. Littelfuse products are not designed for, and may not be used in, all applications. Read complete Disclaimer Notice at <http://www.littelfuse.com/disclaimer-electronics>.

DM Series

Miniature Illuminated Power Rocker Switches

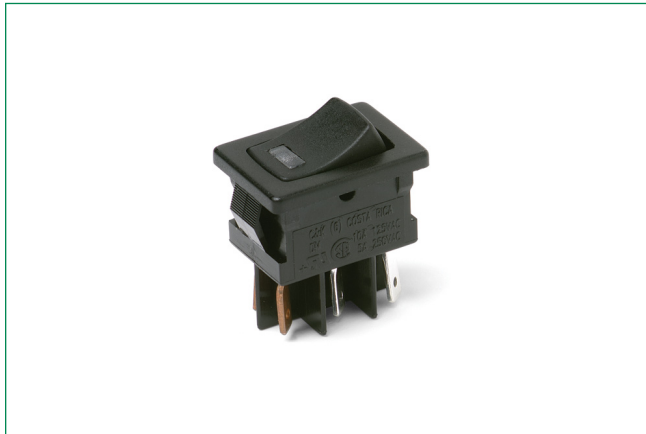

Description

The DM series miniature 2 pole power rocker switch from C&K is commonly found in computers, appliances and electric tools – applications where there is the need for a quick connection and to be sure a device isn't turned on accidentally. DM switches feature quick connect terminals, optional recessed brackets (to prevent accidental actuation) and are double pole in miniature size.

Features & Benefits

- 5 amps to 10 amps
- Illuminated LED
- Positive detent
- RoHS compliant

Applications

- Instrumentation
- Industrial
- Office machines

Agency Approval

Agency	Agency File Number
	E61760

Specifications

Contact Rating	DM54 and DM64 Models: GP (general purpose) 10 amps @ 125 V AC; 5 amps @ 250 V AC (UL). R (resistive) 10 amps 30 VDC 10,000 cycles.
Electrical Life	10,000 make-and-break cycles at full load.
Dielectric Strength	1,000 Vrms min. @ sea level.
Insulation Resistance	10 ⁹ Ω min.
Operating Temperature	-20°C to 65°C

Materials

Actuator & Housing	6/6 nylon (UI 94V-2), black.
Movable Contacts	DM14 and DM24 Models: Copper, silver plated. DM54 and DM64 Models: Coin silver, silver plated.
Stationary Contacts and Terminals	Copper or brass, silver plated.
Contact Spring	Music wire or stainless steel.
LED Terminals	Brass, unplated

Notes:
Any models supplied with Q contact material are RoHS compliant. Specifications and materials listed above are for standard switches. For information on specific and custom switches, consult Customer Service Center.

Ordering Number

To order, simply select desired option from each category and place in the appropriate box. Available options are shown and described on pages G-66 and G-69. For additional options not shown in catalog, consult Customer Service Center.

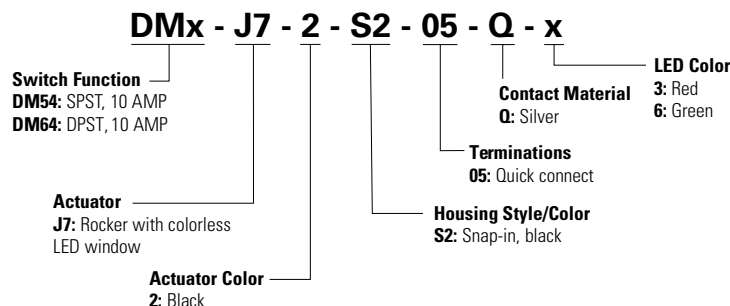

DM Series

Miniature Illuminated Power Rocker Switches



Switch Function DPDT

No. Poles	Model No.	Amp Rating ¹	Switch Function		Connected Terminals		Schematic
			C&K marking on opposite side		POS.1	POS.2	
			POS.1 	POS.2 	POS.1 	POS.2 	
SP	DM54	3 10		OFF	1-1A		
DP	DM64		ON	ON	1-1A, 2-2A	OPEN	

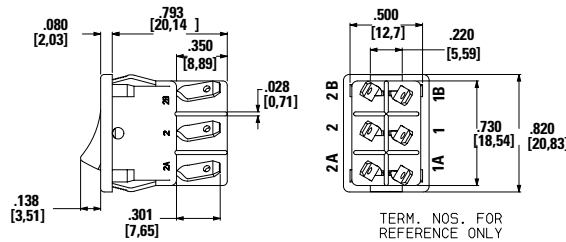

Actuator shown in pos. 1 - 'ON' position.
SPST MODELS (DM54) OMIT TERMINALS 2 & 2A.

Actuator

J7 Rocker with Colorless LED Window

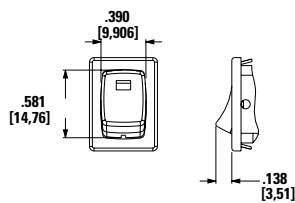

Housing Style/Color

S2 Snap-in, Black

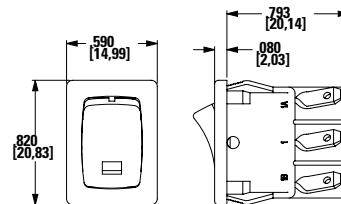

Note: Housing finish: matte. Other colors available, consult Customer Service Center.

Option Code	Actuator Color
2	Black

Note: Other colors available, consult Customer Service Center.

DM Series

Miniature Illuminated Power Rocker Switches



Panel Mounting

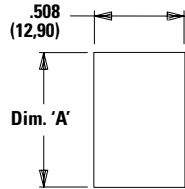

'S2' housing style

Note: Blank insert available for SP models only, see page H-76.

Panel Thickness	DIM 'A' 'S2' Housing Style
0.030 - 0.049 (0.76)(1.24)	0.756 (19.20)
0.049 - 0.079 (1.24)(2.01)	0.764 (19.41)
0.079 - 0.118 (2.01)(3.00)	0.780 (19.81)

Terminations

05 Quick Connect

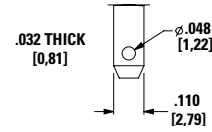

Contact Material

Option Code	Contact and Terminal Material	Ratings	
Q	Silver ^{1,2}	Power	DM54, DM64: GP (general purpose) 10 AMPS @ 125 V AC; 5 AMPS @ 250 V AC. R (resistive) 10 AMPS 30 VDC 10,000 cycles

Notes: See Technical Data section of this catalog for RoHS compliant and compatible definitions and specifications.

1. Movable Contacts: DM54 and DM64 models: Coin silver, silver plated.

2. Stationary Contacts & Terminals: Copper or brass, silver plated.

Note: Any models supplied with Q contact material are RoHS compliant.

LED Color

Option Code	LED Color	Forward ^v FD	Current ^I LED	Reverse ^v R	Intensity ^m CD	Recommended Resistor @ Voltage		
						5V	12V	24V
3	Red	2.1	10	4V	1.6 typ.	270	1K	2.2K
6	Green	2.1	20	4V	2.0 typ.	150	510	1.2K

DM Series

Miniature Illuminated Power Rocker Switches



Available Hardware

Blank Insert

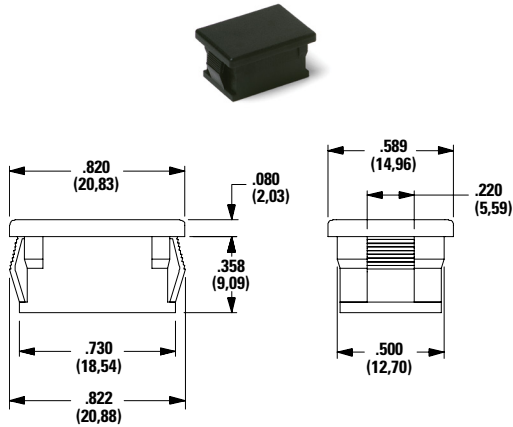

Part No.
057190200 Black
Material: Nylon 6/6
Finish: Matte

Actuator Guard

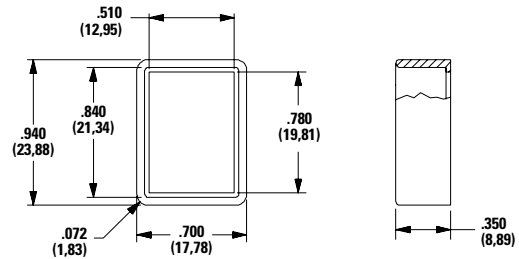

Part No.
104C22000
Material: PBT thermoplastic
Finish: Matte

Disclaimer Notice - Information furnished is believed to be accurate and reliable. However, users should independently evaluate the suitability of and test each product selected for their own applications. Littelfuse products are not designed for, and may not be used in, all applications. Read complete Disclaimer Notice at <http://www.littelfuse.com/disclaimer-electronics>.